

FLOOR PLANS CAPACITY CHARTS

THE WESTIN
EDMONTON



MEETING SPACE OVERVIEW

10135 100th Street
Edmonton, Alberta T5J 0N7 Canada
T 780.426.3636 F 780.428.1454
E westinedmonton@starwoodhotels.com
thewestinedmonton.com

THE WESTIN
EDMONTON

SECOND FLOOR

1. DIRECTOR
2. CONSULATE
3. CHANCELLOR
4. CHAIRMAN
5. WEST FOYER
6. NORTH FOYER
7. BRITISH COLUMBIA
8. ALBERTA
9. YUKON
10. SASKATCHEWAN
11. MANITOBA
12. ATHABASCA
13. LEDUC
14. TURNER VALLEY
15. TANGENT

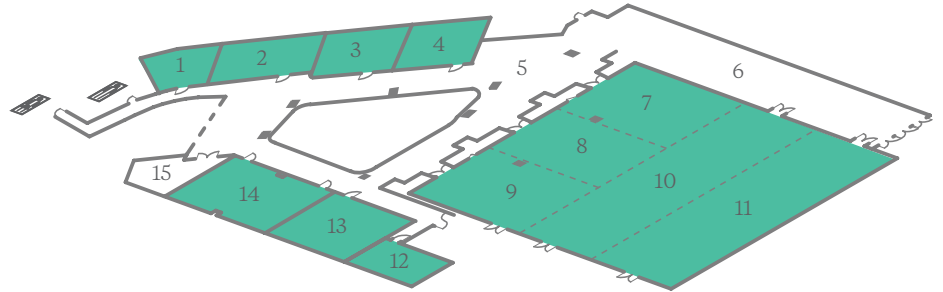

LOBBY LEVEL

1. STRATHCONA
2. CENTENNIAL
3. DEVONIAN

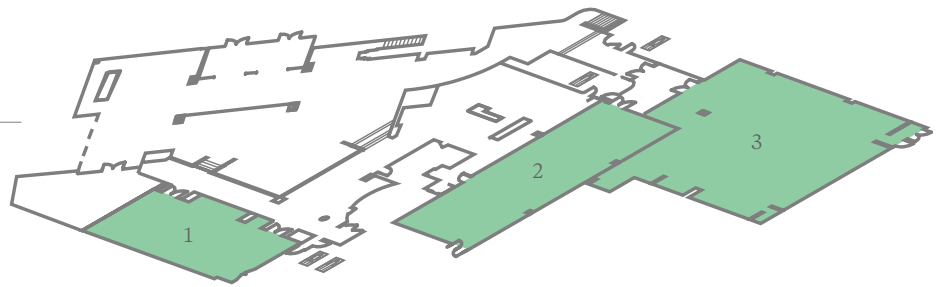

ROOMS AT A GLANCE

TOTAL GUEST ROOMS	416
TOTAL MEETING ROOMS	15
LARGEST MEETING ROOM CAPACITY	1,200
LARGEST MEETING ROOM SIZE	876 m ² / 9,429 ft ²

Additional spaces for meetings and events, not displayed here, may also be available. Contact your hotel representative for more information.

This document contains approximate measurements and square footage that are for illustrative purposes only. We cannot guarantee the floor plan accuracy or completeness, therefore encourage you to review the space to make sure it is suitable for your event.

MEETING SPACE SECOND FLOOR

10135 100th Street
Edmonton, Alberta T5J 0N7 Canada
T 780.426.3636 F 780.428.1454
E westinedmonton@starwoodhotels.com
thewestinedmonton.com

THE WESTIN
EDMONTON

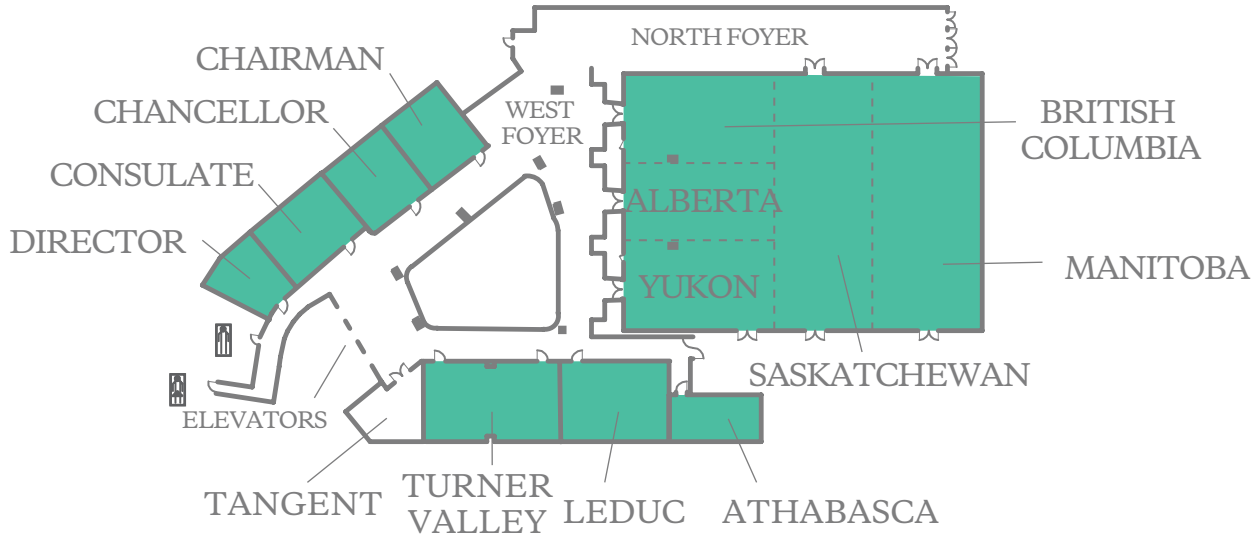

	DIMENSIONS	AREA (SQ. FT.)	MAX CEILING HEIGHT	THEATER	CLASSROOM	BANQUET	CONFERENCE	U-SHAPE	HOLLOW SQ.	RECEPTION
■ ATHABASCA	31' X 16'	472	11'	42	24	30	24	20	24	46
■ BALLROOM	82' X 115'	9,405	12'	1,189	616	860	—	—	—	1,100
■ ALBERTA	25' X 48'	1,200	12'	110	80	80	40	42	44	100
■ ALBERTA-BRITISH COLUMBIA	53' X 48'	2,562	12'	242	148	190	48	54	60	200
■ BRITISH COLUMBIA	29' X 48'	1,367	12'	120	80	100	40	46	48	100
■ MANITOBA	82' X 36'	2,937	12'	294	168	240	72	84	88	270
■ MANITOBA-SASKATCHEWAN	82' X 66'	5,402	12'	576	312	480	72	88	96	510
■ SASKATCHEWAN	82' X 30'	2,465	12'	264	136	210	72	80	80	240
■ SKATCHEWAN-YUKON-ALBERTA-BRITISH COLUMBIA	82' X 78'	6,396	12'	622	308	540	—	—	—	550
■ YUKON	29' X 48'	1,344	12'	120	80	100	40	42	48	100
■ YUKON-ALBERTA	54' X 48'	2,570	12'	242	148	190	48	54	60	200
■ YUKON-ABLERTA-BRITISH COLUMBIA	82' X 48'	3,956	12'	369	252	300	—	—	—	310
■ CHAIRMAN	26' X 27'	688	11'	60	32	40	20	24	28	59
■ CHANCELLOR	26' X 27'	688	11'	60	32	40	20	24	28	57
■ CONSULATE	27' X 22'	590	11'	50	32	40	24	24	28	64
■ DIRECTOR	22' X 11'	350	11'	30	12	20	16	—	16	38
■ LEDUC	33' X 25'	830	11'	80	48	60	28	32	36	83
NORTH FOYER	20' X 130'	2,600	11'	—	—	—	—	—	—	284
TANGENT	25' X 13'	325	11'	—	—	—	4	—	—	42
■ TURNER VALLEY	43' X 25'	1,087	11'	100	64	80	36	38	44	107
WEST FOYER	10' X 380'	3,800	11'	—	—	—	—	—	—	200

This document contains approximate measurements and square footage that are for illustrative purposes only. We cannot guarantee the floor plan accuracy or completeness, therefore encourage you to review the space to make sure it is suitable for your event.

MEETING SPACE LOBBY LEVEL

10135 100th Street
Edmonton, Alberta T5J 0N7 Canada
T 780.426.3636 F 780.428.1454
E westinedmonton@starwoodhotels.com
thewestinedmonton.com

THE WESTIN
EDMONTON

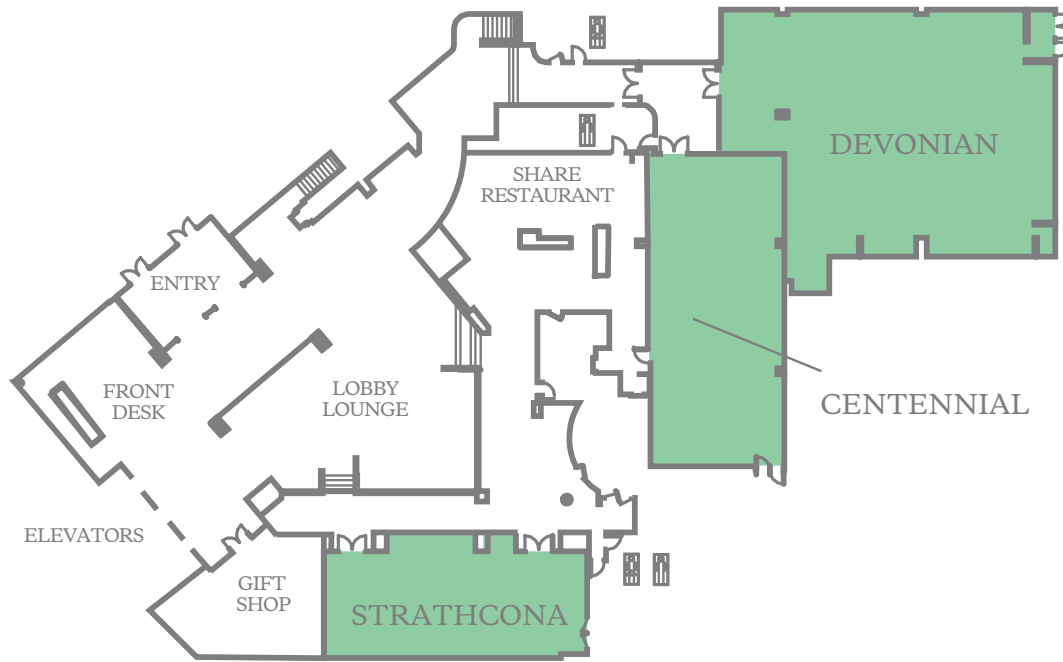

	DIMENSIONS	AREA (SQ. FT.)	MAX CEILING HEIGHT	THEATER	CLASSROOM	BANQUET	CONFERENCE	U-SHAPE	HOLLOW SQ.	RECEPTION
■ CENTENNIAL	69' X 29'	1,946	11'	216	112	160	60	64	64	204
■ DEVONIAN	73' X 53'	3,505	12.5'	294	192	210	48	70	80	250
■ STRATHCONA	142' X 228'	1,416	10'	112	80	100	40	44	44	149

This document contains approximate measurements and square footage that are for illustrative purposes only. We cannot guarantee the floor plan accuracy or completeness, therefore encourage you to review the space to make sure it is suitable for your event.



10135 100th Street
Edmonton, Alberta T5J 0N7 Canada
T 780.426.3636 F 780.428.1454
E westinedmonton@starwoodhotels.com
thewestinedmonton.com

THE WESTIN
EDMONTON